

PURLIN BOX

PURLIN BOX

Overview

- Pre-galvanised mild steel

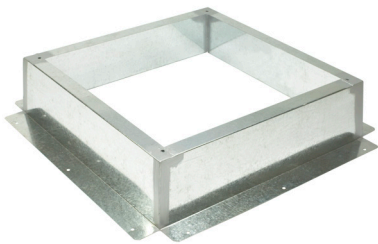

Product Code	A	B	C	D	Weight kg
039B-PB25	430	428	582	240	6
039B-PB31/35	570	610	790	240	9
039B-PB40/45	690	730	970	250	11
039B-PB50/56	820	860	1040	250	13
039B-PB63/71	960	1000	1180	250	15
039B-PB80	1080	1076	1230	270	17

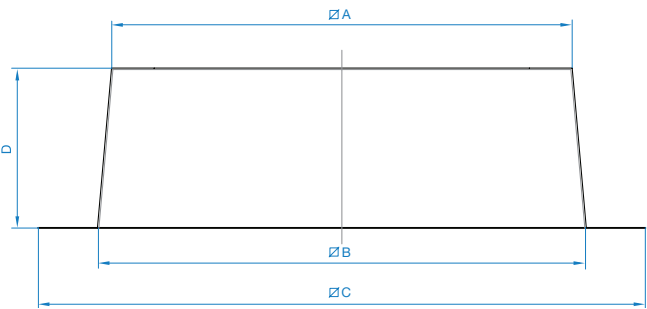

Dimensions are in mm.

PURLIN BOX

Notes

Building Services

Tel **+44 (0) 1384 275800**
Fax **+44 (0) 1384 275810**
Email **info@eltafans.co.uk**

46 Third Avenue, Pensnett Trading Estate, Kingswinford,
West Midlands, DY6 7US United Kingdom

Applied Technology & Building Services Export

Tel **+44 (0) 1489 566500**
Fax **+44 (0) 1489 566555**
Email **at@eltafans.co.uk / export@eltafans.co.uk**

17 Barnes Wallis Road, Segensworth East Industrial Estate,
Fareham, Hampshire, PO15 5ST United Kingdom

eltafans.com

039B-03-2018 Issue A



BS EN ISO 9001:2015 FM 556465



A MEMBER OF  ELTA GROUP