

Project : Customer : Project Code :
Quotation : Date : 11 June 2025

Image of fan
JM Aerofoil
List Price - GLOBAL - GBP [5.25]
56JM/20/2/6/
1 day - (Fan Only)
Lead time may vary based on stock availability at time of order. Please refresh the lead time in the project or reselect the fan before placing an order.

Table with 2 columns: Product, Details. Rows include Model Code, Fan Diameter, Impeller, Installation, Fan Casing.

Table with 2 columns: Performance, Details. Rows include Requested Duty, Actual Duty, Outlet Dynamic Pressure, Velocity.

Table with 2 columns: Motor, Details. Rows include Motor Rating, Full Load Current, Starting Current, Electrical Supply, Motor Winding, Motor Type.

Table with 2 columns: Efficiency Grades, Details. Row includes ErP [FMEG] Rating.

Table with 2 columns: Environment, Details. Rows include Air Density, Smoke Venting, Operating Environment.

PRODUCT DIMENSIONS

Technical drawings of the fan showing front and side views with dimensions (82 kg, 520, 560, 714, etc.) and a note about dimensions being a guide only.

Table with 2 columns: Mechanical, Details. Rows include Casing, Impeller, Operating Temperatures, Weight.

COMMENTS

FAN PERFORMANCE CURVE

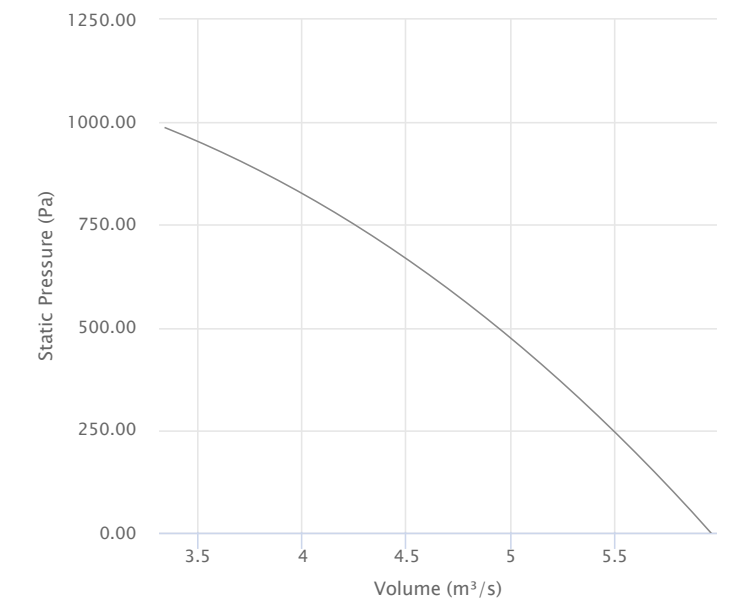

ACOUSTICS

Table with 3 main sections: Sound Spectrum (Hz), Overall, and Distance (3 m). Rows include frequency bands (125, 250, 500, 1k, 2k, 4k, 8k), Lw*, LwA*, and LpA @ 3 m.**

FAN & ACCESSORIES

Table with 5 columns: Item Description, Part Number, Qty, Lead-Time, Price (sum). Rows include fan details and a Total Price row.

Project :

Customer :

Project Code :

Quotation :

Date : 11 June 2025

AERODYNAMIC

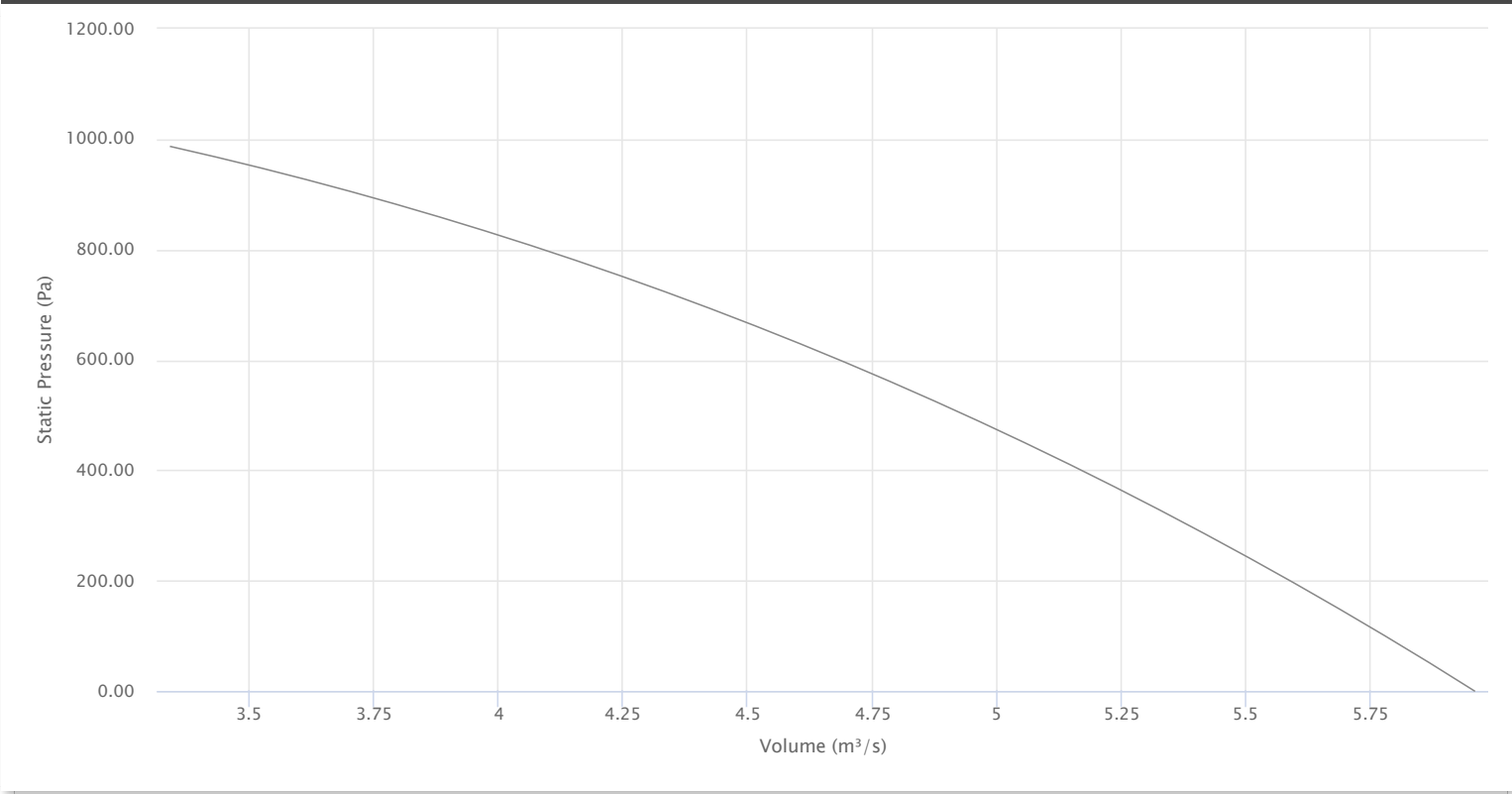

POWER CHART

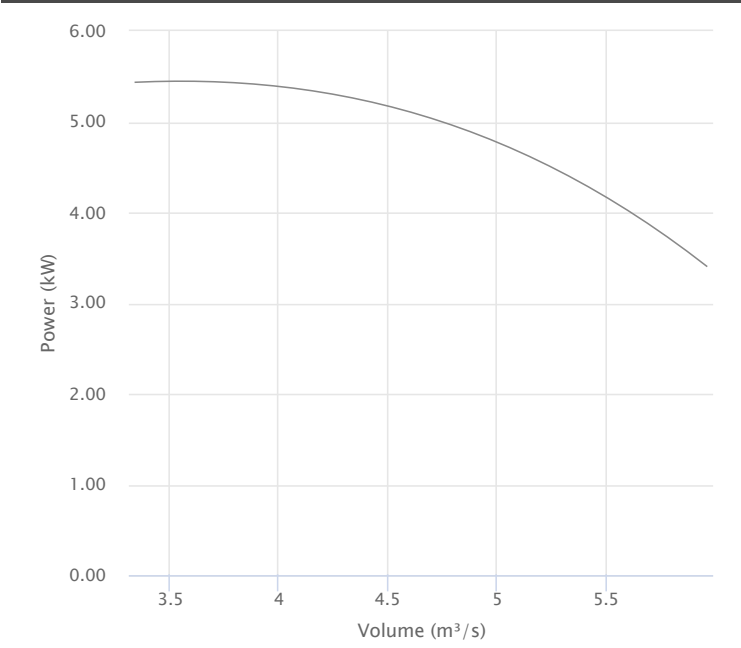

EFFICIENCY CHART

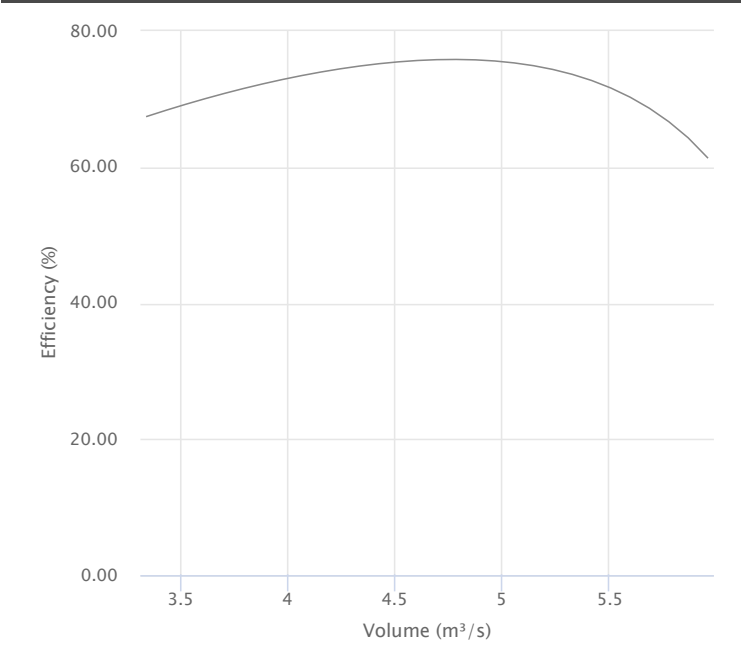

ACOUSTICS

Sound Spectrum (Hz)								Overall
125	250	500	1k	2k	4k	8k	Lw*	LpA @ 3 m **
Sound Data At Requested Duty . * Lw dB re 10 ⁻¹² W ** dBA re 2x10 ⁻⁵ Pa								

Project :
Quotation :

Customer :

Project Code :
Date : 11 June 2025

PRODUCT DIMENSIONS

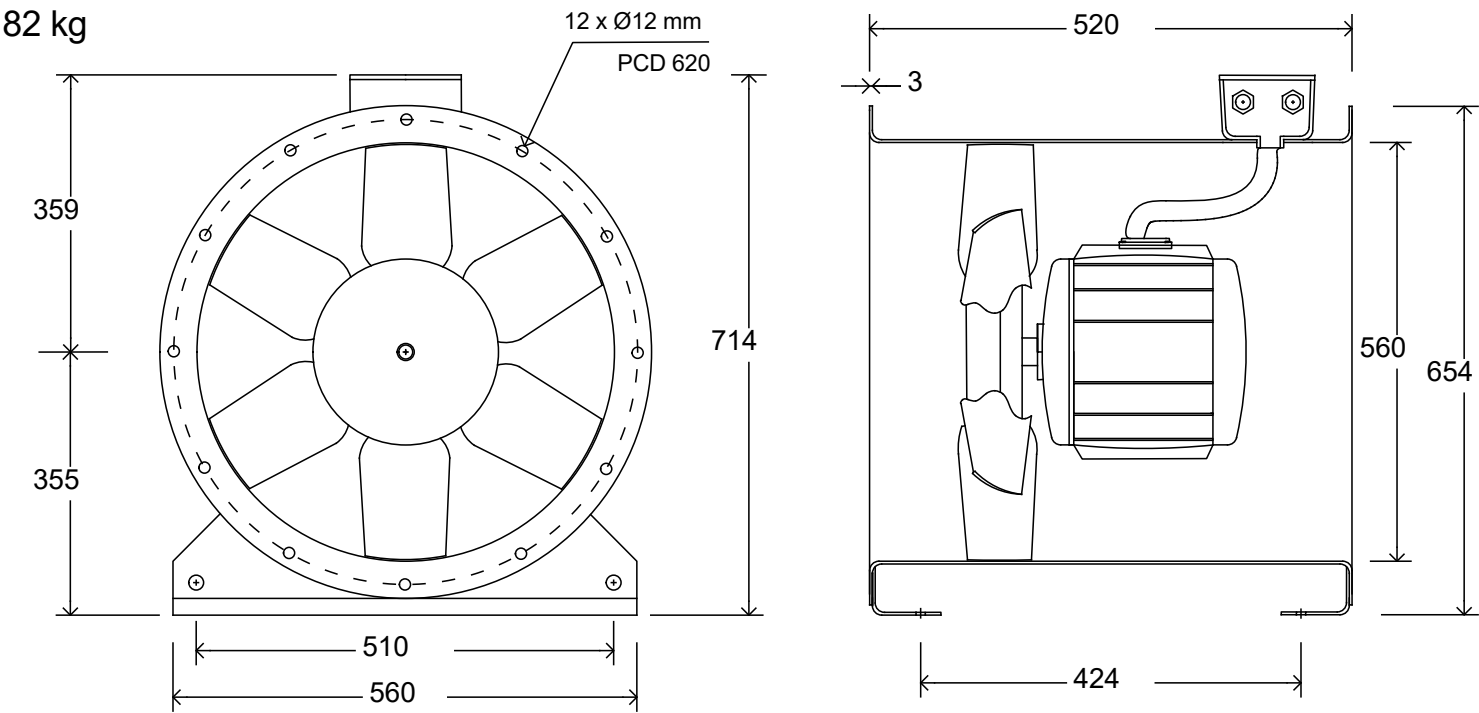

ACCESSORY DIMENSIONS

Project :	Customer :	Project Code :
Quotation :		Date : 11 June 2025

JM AEROFOIL

ENVIRONMENT NOTES

Fans are designed for Continuous operation from -40°C to +50°C, but is suitable for frequent starting down to -20°C.

HIGH TEMPERATURE NOTES

High Temperature Notes

PERFORMANCE NOTES

Performance data has been derived from tests carried out in a Flakt Woods laboratory, in accordance with ISO 5801 and is specifically applicable for Ducted installations. When an electronic controller is incorporated, motor noise may increase slightly - particularly when the operating speed is well below maximum. We therefore recommend using an auto transformer speed controller for noise sensitive applications. Bifurcated Axial fans are ErP exempt, where the in-duct air temperature is continuously greater than 100°C. This fan variant should not be used within EEA countries at lower temperatures

ACOUSTIC NOTES

Acoustic data has been derived from tests carried out in a Flakt Woods laboratory, in accordance with BS 848 Pt 2 / ISO 5136 under Ducted conditions. The LpA figure provided is the overall Inlet sound pressure level calculated at the specified distance, under spherical, free field conditions. Breakout levels stated are estimated from induct sound power levels and are provided for guidance. Acoustic figures for adjusted running speeds have been interpolated and are for reference only.