



CAB

5113212400 - CAB-200 (230V50/60) R8 - ACOUSTIC CABINET FANS



Centrifugal fan cabinet with manufactured from galvanised sheet steel, acoustic and fire retardant lining 50 mm thick. Forward curved centrifugal fan with closed single-phase motor and speed controllable. IP44, B Brand S&P model CAB-200 (230V50/60) R8.

Theoretical Working Point

| | |
|-----------------|-----------------------|
| Airflow | - |
| Static Pressure | 0,000 Pa |
| Temperature | 20 °C |
| Altitude | 0 m |
| Density | 1,2 kg/m ³ |
| Frequency | 50 Hz |

Construction

| | |
|--------------------|----------|
| Discharge diameter | 200 mm |
| Fan size | 133/126 |
| Weight | 22,00 kg |

Motor Characteristics

| | |
|--------------------------|-------------|
| Number of poles | 2 |
| Voltage | 1-230V-50Hz |
| Maximum absorbed current | 1,3 A |
| IP Rating | IP44 |
| Motor insulation class | B |

Drawing

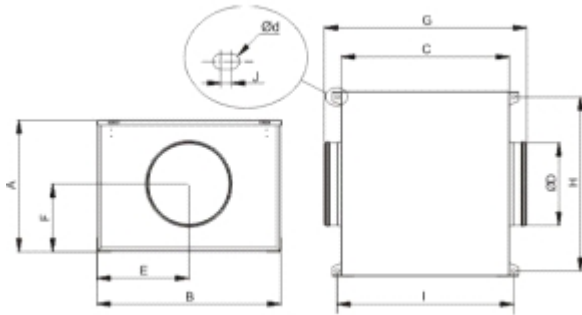

| A | B | C | D | E | F | G | H | I |
|-----|-----|-----|-----|-----|-----|-----|-----|-----|
| 328 | 430 | 365 | 200 | 216 | 210 | 475 | 397 | 394 |

| J | Ød |
|-----|-----|
| 6.5 | 4.5 |

Performance Chart

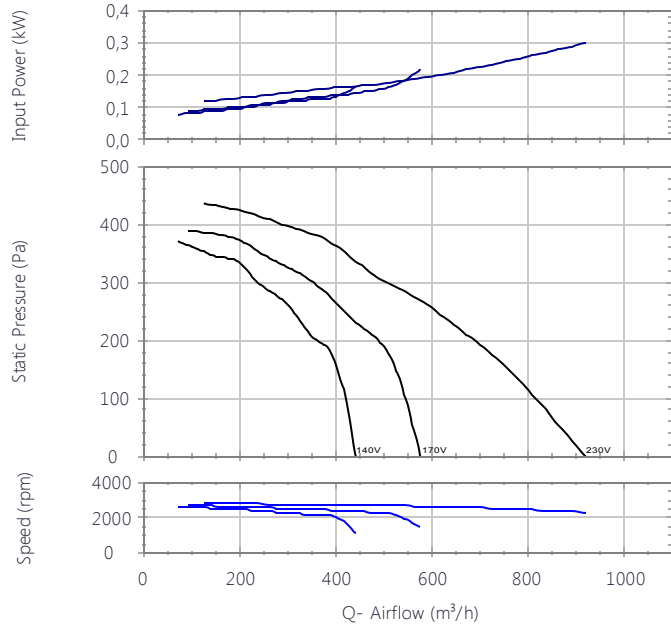

Sound Performance

| | 63 | 125 | 250 | 500 | 1k | 2k | 4k | 8k | Overall |
|--------------------------|----|-----|-----|-----|----|----|----|----|---------|
| Inlet (LwA) | 47 | 57 | 52 | 50 | 51 | 52 | 47 | 42 | 61 |
| Inlet LpA @ 1m | 36 | 46 | 41 | 40 | 40 | 41 | 36 | 31 | 50 |
| Outlet (LwA) | 42 | 58 | 58 | 64 | 70 | 69 | 65 | 61 | 74 |
| Outlet LpA @ 1m | 31 | 47 | 47 | 53 | 59 | 58 | 54 | 50 | 63 |
| Breakout (LwA) | 32 | 49 | 41 | 36 | 39 | 38 | 31 | 28 | 51 |
| Breakout LpA @ 1m | 22 | 39 | 30 | 25 | 28 | 27 | 20 | 17 | 40 |





CAB

5113212400 - CAB-200 (230V50/60) R8 - ACOUSTIC CABINET FANS



Performance Chart

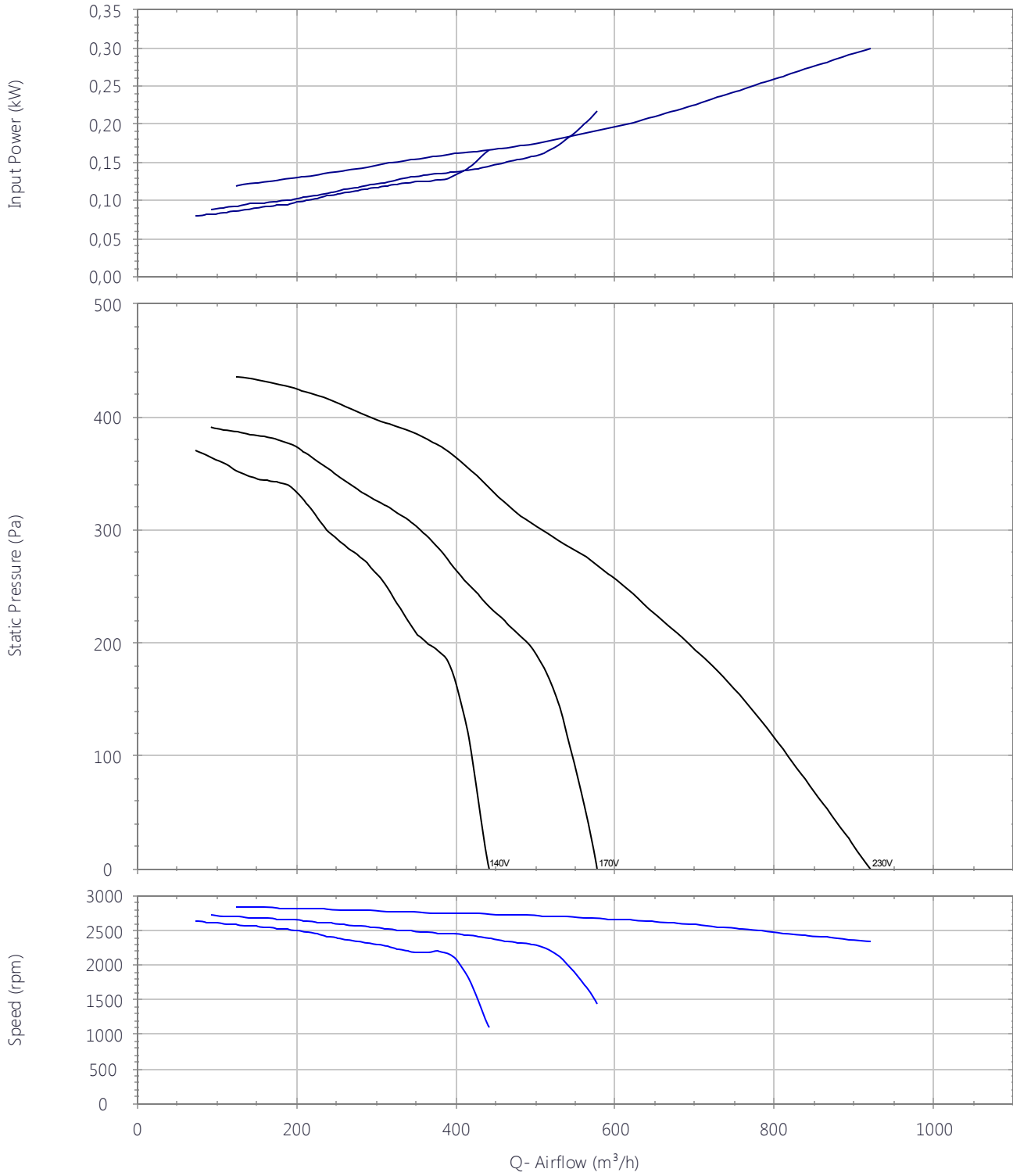



Sound Performance

| | 63 | 125 | 250 | 500 | 1k | 2k | 4k | 8k | Overall |
|--------------------------|----|-----|-----|-----|----|----|----|----|---------|
| Inlet (LwA) | 47 | 57 | 52 | 50 | 51 | 52 | 47 | 42 | 61 |
| Inlet LpA @ 1m | 36 | 46 | 41 | 40 | 40 | 41 | 36 | 31 | 50 |
| Outlet (LwA) | 42 | 58 | 58 | 64 | 70 | 69 | 65 | 61 | 74 |
| Outlet LpA @ 1m | 31 | 47 | 47 | 53 | 59 | 58 | 54 | 50 | 63 |
| Breakout (LwA) | 32 | 49 | 41 | 36 | 39 | 38 | 31 | 28 | 51 |
| Breakout LpA @ 1m | 22 | 39 | 30 | 25 | 28 | 27 | 20 | 17 | 40 |



Drawing

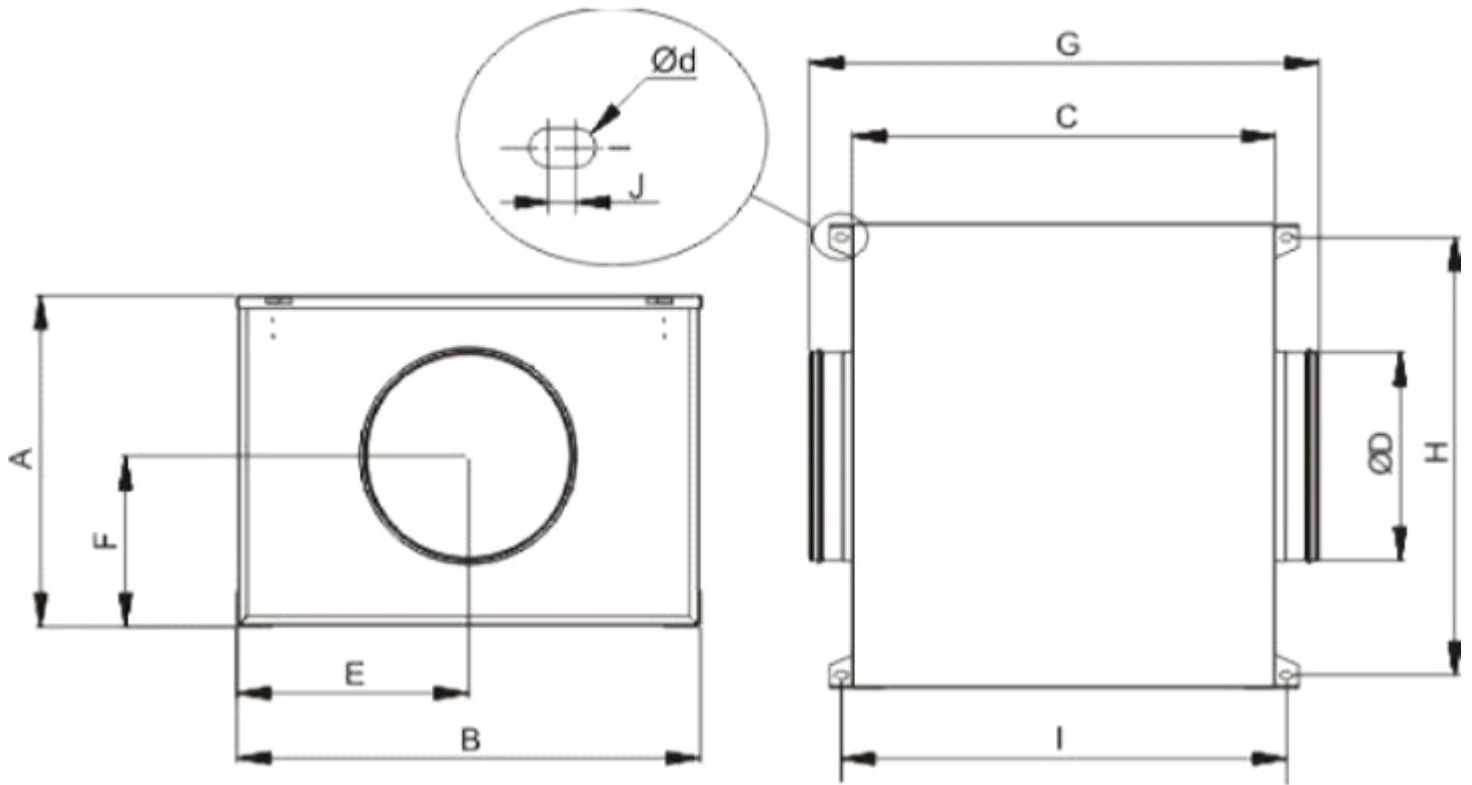

| A | B | C | D | E | F | G | H | I | J | Ød |
|-----|-----|-----|-----|-----|-----|-----|-----|-----|-----|-----|
| 328 | 430 | 365 | 200 | 216 | 210 | 475 | 397 | 394 | 6.5 | 4.5 |

Accessories

5401620900 - CONTROL ECOWATT AC/4A (230VAC 50HZ)



Control element for demand controlled ventilation systems in public, commercial residential building it automatically modifies the fan speed to adapt it to the needs defined in the system, measured with sensors. It has three basic modes of operation: 1. Integral proportional control at constant pressure. 2. Proportional control with maximum demand criteria with multiple sensor input: temperature, CO2 and relative humidity. 3. Minimum-maximum control with three-sensor input: CO2, temperature, relative humidity or presence detectors (PIR). DC signal output of 1 to 10 V or signal output for AC voltage variation for single phase motors at 230 V. ECOWATT C CONTROL: for single phase ventilation units. ECOWATT C CONTROL: for DC ventilation units. Power supply:- AC model: 1~230 V. - DC model: 1~230 V or 24 VDC..

Dimensions

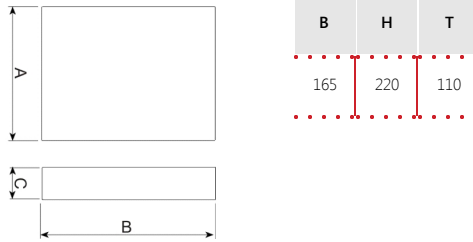

5401306500 - COM-3

Three-speed switch.Fan ON/OFF and speed selector.Maximum current rating 4A.



Dimensions

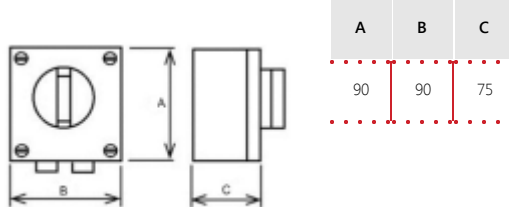

5401643000 - CONTROL ETT-6

Electronic step controller. Can control activation of up to six devices. Can be used to switch on and off heating systems (EC wall-mounted fan heaters or TERMOTECH radiant panels) or for ventilations systems with several units.





CAB

5113212400 - CAB-200 (230V50/60) R8 - ACOUSTIC CABINET FANS

5401272900 - REB-2.5 N (230V 50)



Electronic speed controller

Dimensions

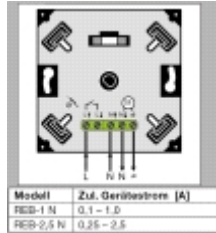

| A | B | C |
|----|----|----|
| 80 | 22 | 46 |

| Modell | Zul. Geratstrom [A] |
|-----------|----------------------|
| REB-1 N | 0,1 - 1,0 |
| REB-2,5 N | 0,25 - 2,5 |

5401273700 - REB-2.5 N E (230V 50)



Electronic speed controller

5401245500 - RMB-1,5 (220V 50Y60)

AUTOTRANSFORMER SPEED CONTROLLER

Dimensions

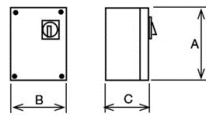

| A | B | C |
|-----|-----|----|
| 230 | 180 | 95 |



CAB

5113212400 - CAB-200 (230V50/60) R8 - ACOUSTIC CABINET FANS

5401640600 - INTER 4P

Three speed switch.Fan ON/OFF and speed selector.Maximum current rating 4A.



Dimensions

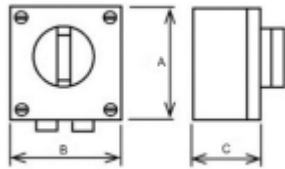

| A | B | C |
|----|----|------|
| 86 | 86 | 60.4 |

5211803100 - MBE-200/50T 2/400V

Electric Heater Battery



Dimensions

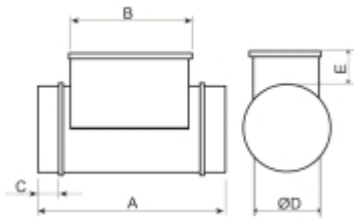

| A | B | C | D | E |
|-----|-----|----|-----|-----|
| 400 | 285 | 50 | 200 | 105 |

5132864300 - MBW-200

Hot-water coil

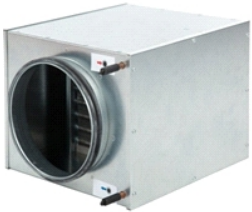

Dimensions

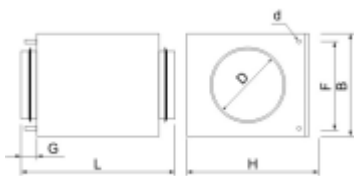

| B | D | H | J | K | L | R |
|-----|-----|-----|----|-----|-----|----|
| 258 | 200 | 305 | 40 | 215 | 380 | 10 |



CAB

5113212400 - CAB-200 (230V50/60) R8 - ACOUSTIC CABINET FANS

5416579000 - MFL-200 G4



MFL filtration boxes are of G4 grade filtration and are designed for direct connection with standard circular ducting. The MFL-G4 filtration boxes are supplied with a cover easily removable to replace the filter.

Dimensions

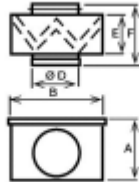

| A | B | D | E | F |
|-----|-----|-----|-----|-----|
| 246 | 269 | 200 | 154 | 218 |

5130861700 - KSE-45

Rubber anti-vibration mounts that absorb vibration and attenuate the noise produced in the installation. (1 KSE = 4 supports in a bag)



Dimensions

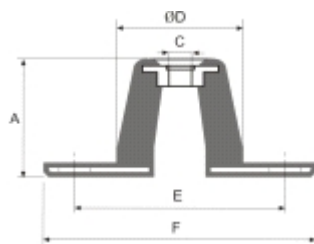

| A | C | D | E | F |
|----|---|----|----|----|
| 24 | 8 | 30 | 65 | 90 |

5137916200 - APC-200

Protection guards for direct connection to the inlet-outlet fan flange connector.



Dimensions

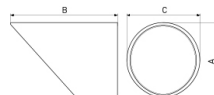

| A | B |
|-----|-----|
| 200 | 275 |



CAB

5113212400 - CAB-200 (230V50/60) R8 - ACOUSTIC CABINET FANS

5416466000 - GSI-M0/M1 200 10M

INSULATED ALUMINIUM FLEXIBLE DUCTING



Dimensions

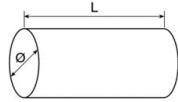

| D | L |
|-----|----|
| 200 | 10 |

5209192500 - GSI-M0/M1 200 3M

INSULATED ALUMINIUM FLEXIBLE DUCTING



Dimensions

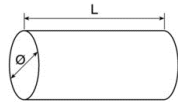

| D | L |
|-----|---|
| 200 | 3 |

5211811400 - SIL-200

Silencer to be installed either at the inlet or outlet of the fan.



Corrections

| 63 | 125 | 250 | 500 | 1k | 2k | 4k | 8k |
|----|-----|-----|-----|-----|-----|-----|-----|
| -0 | -3 | -7 | -16 | -22 | -20 | -13 | -10 |

Dimensions

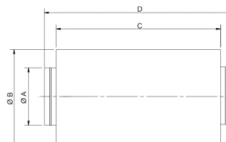

| A | B | C | D |
|-----|-----|-----|-----|
| 200 | 300 | 600 | 700 |



CAB

5113212400 - CAB-200 (230V50/60) R8 - ACOUSTIC CABINET FANS

5209161900 - EC 22 N BLANCO RAL 9016

Self-regulating air vents, manufactured in white or brown polystyrene. Guaranteeing air renewal in a home through the main rooms (Living room, sitting room and bedrooms). Enabling an airflow of 22, 30 and 45 m³/h. Fitted either to carpentry elements (in openings measuring 354x12 mm) or connected to a wall feedthrough tube. The EC N air vent can have a cover that includes an insect grille, available in white or brown.



Dimensions

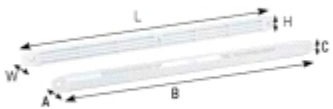

| A | B | C | H | L | W |
|----|-----|----|----|-----|---|
| 20 | 305 | 18 | 20 | 295 | 8 |

5209162000 - EC 30 N BLANCO RAL 9016

Self-regulating air vents, manufactured in white or brown polystyrene. Guaranteeing air renewal in a home through the main rooms (Living room, sitting room and bedrooms). Enabling an airflow of 22, 30 and 45 m³/h. Fitted either to carpentry elements (in openings measuring 354x12 mm) or connected to a wall feedthrough tube. The EC N air vent can have a cover that includes an insect grille, available in white or brown.



Dimensions

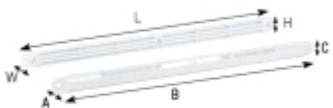

| A | B | C | H | L | W |
|----|-----|----|----|-----|---|
| 20 | 305 | 18 | 20 | 295 | 8 |

5209162100 - EC 45 N BLANCO RAL 9016

Self-regulating air vents, manufactured in white or brown polystyrene. Guaranteeing air renewal in a home through the main rooms (Living room, sitting room and bedrooms). Enabling an airflow of 22, 30 and 45 m³/h. Fitted either to carpentry elements (in openings measuring 354x12 mm) or connected to a wall feedthrough tube. The EC N air vent can have a cover that includes an insect grille, available in white or brown.



Dimensions

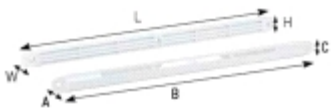

| A | B | C | H | L | W |
|----|-----|----|----|-----|----|
| 24 | 390 | 20 | 23 | 400 | 12 |

5209163400 - ECA 22 BLANCO RAL9016

Self-regulating air vents, manufactured from injection moulded polystyrene and available in three air volume range (22, 30, 36 and 45 m³/h). Fitted in openings measuring 354x12 mm. Suitable for installation on window joinery by crews. The air inlet acoustic element is placed on the indoor side while the cover is fitted on the external side of the joinery. An additional acoustic element can be slot into the air inlet (ECA+RA).



Dimensions



| A | B | C | H | L | W |
|----|-----|----|----|-----|----|
| 45 | 422 | 45 | 23 | 400 | 12 |

5209162500 - ECA 22 RA BLANCO RAL 9016

Self-regulating air vents, manufactured from injection moulded polystyrene. They allow air renewal in a house via main rooms (living room, dining room, bathroom). Airflow of 22, 30, 36 and 45 m³/h. It can be installed on carpentry elements or joined to a wall bypass sleeve.

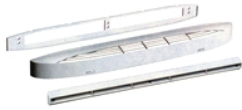

Dimensions



| A | B | C | H | L | W |
|----|-----|----|----|-----|----|
| 69 | 422 | 45 | 23 | 400 | 12 |

5209163700 - ECA 30 BLANCO RAL9016

Self-regulating air vents, manufactured from injection moulded polystyrene and available in three air volume range (22, 30, 36 and 45 m³/h). Fitted in openings measuring 354x12 mm. Suitable for installation on window joinery by crews. The air inlet acoustic element is placed on the indoor side while the cover is fitted on the external side of the joinery. An additional acoustic element can be slot into the air inlet (ECA+RA).



Dimensions



| A | B | C | H | L | W |
|----|-----|----|----|-----|----|
| 45 | 422 | 45 | 23 | 400 | 12 |



CAB

5113212400 - CAB-200 (230V50/60) R8 - ACOUSTIC CABINET FANS

5209162600 - ECA 30 RA BLANCO RAL 9016

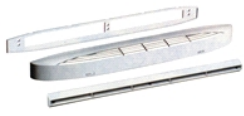

Self-regulating air vents, manufactured from injection moulded polystyrene. They allow air renewal in a house via main rooms (living room, dining room, bathroom). Airflow of 22,30, 36 and 45 m³/h. It can be installed on carpentry elements or joined to a wall bypass sleeve.

Dimensions



| A | B | C | H | L | W |
|----|-----|----|----|-----|----|
| 69 | 422 | 45 | 23 | 400 | 12 |

5209172100 - ECA 36 BLANCO RAL9016



Self-regulating air vents, manufactured from injection moulded polystyrene and available in three air volume range (22, 30, 36 and 45 m³/h). Fitted in openings measuring 354x12 mm. Suitable for installation on window joinery by crews. The air inlet acoustic element is placed on the indoor side while the cover is fitted on the external side of the joinery. An additional acoustic element can be slot into the air inlet (ECA+RA).

Dimensions



| A | B | C | H | L | W |
|----|-----|----|----|-----|----|
| 45 | 422 | 45 | 23 | 400 | 12 |

5209172200 - ECA 36 RA BLANCO RAL 9016

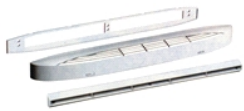

Self-regulating air vents, manufactured from injection moulded polystyrene. They allow air renewal in a house via main rooms (living room, dining room, bathroom). Airflow of 22,30, 36 and 45 m³/h. It can be installed on carpentry elements or joined to a wall bypass sleeve.

Dimensions



| A | B | C | H | L | W |
|----|-----|----|----|-----|----|
| 69 | 422 | 45 | 23 | 400 | 12 |

5209164000 - ECA 45 BLANCO RAL9016

Self-regulating air vents, manufactured from injection moulded polystyrene and available in three air volume range (22, 30, 36 and 45 m³/h). Fitted in openings measuring 354x12 mm. Suitable for installation on window joinery by crews. The air inlet acoustic element is placed on the indoor side while the cover is fitted on the external side of the joinery. An additional acoustic element can be slot into the air inlet (ECA+RA).



Dimensions



| A | B | C | H | L | W |
|----|-----|----|----|-----|----|
| 45 | 422 | 45 | 23 | 400 | 12 |

5209162700 - ECA 45 RA BLANCO RAL 9016

Self-regulating air vents, manufactured from injection moulded polystyrene. They allow air renewal in a house via main rooms (living room, dining room, bathroom). Airflow of 22,30, 36 and 45 m³/h. It can be installed on carpentry elements or joined to a wall bypass sleeve.

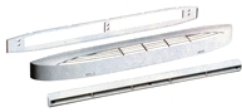

Dimensions



| A | B | C | H | L | W |
|----|-----|----|----|-----|----|
| 69 | 422 | 45 | 23 | 400 | 12 |

5209172400 - ECA HY 6/45 BLANCO RAL 9016

Humidity adjustable acoustic air vents for renewing air in the main rooms of flats and detached homes. They guarantee a variable flow of 6 to 45 m³/h according to the degree of humidity in the room, for a pressure difference of 20 Pa. It can be installed on carpentry elements or joined to a wall bypass sleeve.



Dimensions



| A | B | C | H | L | W |
|----|-----|----|----|-----|----|
| 45 | 420 | 40 | 23 | 400 | 12 |



CAB

5113212400 - CAB-200 (230V50/60) R8 - ACOUSTIC CABINET FANS

5209172500 - ECA HY 6/45 RA BLANCO RAL 9016

Humidity adjustable air vents with an acoustic frame for renewing air in the main rooms of flats and detached homes. The acoustic frame offers great noise attenuation. They guarantee a variable flow of 6 to 45 m³/h according to the degree of humidity in the room, for a pressure difference of 20 Pa. It can be installed on carpentry elements or joined to a wall bypass sleeve.



Dimensions

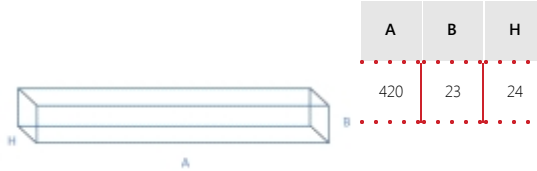

5209172300 - EC HY 6/45 BLANCO RAL 9016

Humidity adjustable air vents for renewing air in the main rooms of flats and detached homes. They guarantee a variable flow of 6 to 45 m³/h according to the degree of humidity in the room, for a pressure difference of 20 Pa. It can be installed on carpentry elements or joined to a wall bypass sleeve.



Dimensions

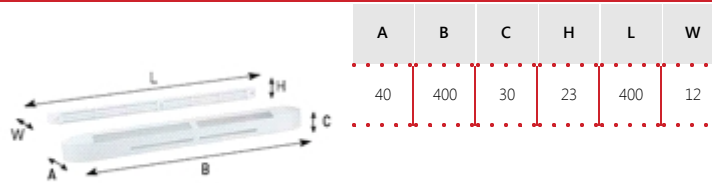

5209195800 - SILEM KIT 22

Humidity adjustable air vents with sound attenuator. SILEM KIT HY allows air renewal in a house via main rooms (living room, dining room, bathroom). Airflow of 22 and 30 m³/h. They are fitted into the wall. With this purpose, it is included a sheet metal sleeve (Ø 125 mm and 300 mm length) and external facade grille.



Dimensions

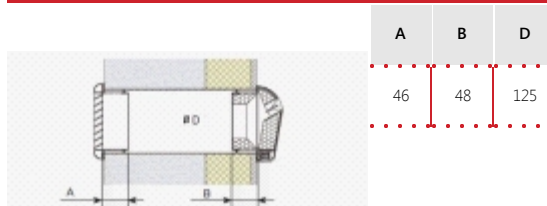



CAB

5113212400 - CAB-200 (230V50/60) R8 - ACOUSTIC CABINET FANS

5209195900 - SILEM KIT 30



Humidity adjustable air vents with sound attenuator. SILEM KIT HY allows air renewal in a house via main rooms (living room, dining room, bathroom). Airflow of 22 and 30 m³/h They are fitted into the wall. With this purpose, it is included a sheet metal sleeve (Ø 125 mm and 300 mm length) and external facade grille.

Dimensions

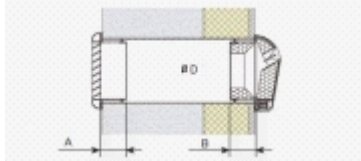

| A | B | D |
|----|----|-----|
| 46 | 48 | 125 |

5209196100 - SILEM KIT HY 125



Humidity adjustable air vents with sound attenuator. SILEM KIT HY allows air renewal in a house via main rooms (living room, dining room, bathroom). Airflow of 22 and 30 m³/h They are fitted into the wall. With this purpose, it is included a sheet metal sleeve (Ø 125 mm and 300 mm length) and external facade grille.

Dimensions

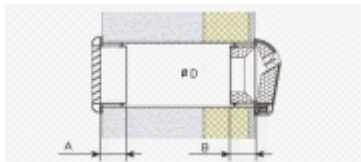

| A | B | D |
|----|----|-----|
| 46 | 48 | 125 |

5416406600 - BOC-200

inlet connector at the end of the duct





CAB

5113212400 - CAB-200 (230V50/60) R8 - ACOUSTIC CABINET FANS

5416556800 - GCI-200

Circular supply / exhaust grilles.



5416562600 - VR-200

Mounting support to facilitate the installation of the GCI circular grilles and connection to ducting.



Dimensions

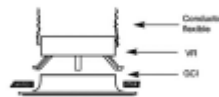

| D |
|-----|
| 190 |

5401285100 - INTERRUPTOR PARO-MARCHA 5P

Rotatory switch. Maximum current rating 20 A. 5 wires for two speed motors. IP-66-IP-67 protection 3x380V, 440V.



Dimensions

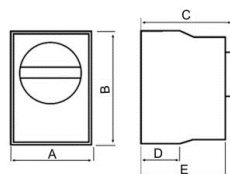

| B | H | T |
|----|----|-----|
| 86 | 86 | 120 |



CAB

5113212400 - CAB-200 (230V50/60) R8 - ACOUSTIC CABINET FANS

5416582400 - TG-K330 (STC)



Duct temperature sensor. Used in conjunction with electric heater and controller. NTC type with liner scale. Protection class IP20.- TG-K330: from 0 to 30°C.

5416578200 - TG-R530 (STA)



Used in conjunction with electric heaters and controllers. NTC type with liner scale. Range of temperature 0-30°C. Protection class IP30.- Room sensor without set point adjustment, 0-30°C (TG-R530).

5132868000 - TT-S1

POWER AMPLIFIER



Dimensions

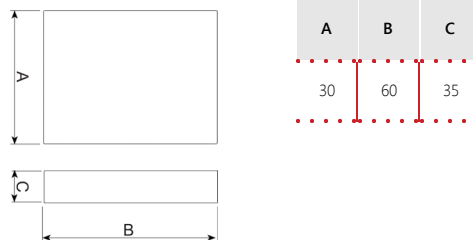

5416354800 - PULSER M



Single phase electric heater controller. Supplementary unit for slave control from another PULSER to control electric heaters with power ratings high to the PULSER capacity (3600W-230V).

Dimensions



| A | B | C |
|----|-----|----|
| 83 | 153 | 40 |

5416365400 - PULSER-ADD



Single phase electric heater controller. Set point: 0-30°C, the sensor determines the scale range (for use with NTC-sensor). Output (load): 16 A (min. 1 A). Protection class: IP30. Input regulation maximum and minimum. Maximum absorbed power: 3.6 kW.

Dimensions



| A | B | C |
|----|-----|----|
| 83 | 153 | 40 |

5138920500 - ACOPEL F400-200/160 N

FLEXIBLE CONNECTOR



Dimensions

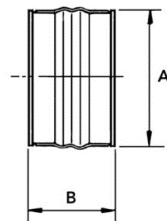

| A | B |
|-----|-----|
| 203 | 160 |



CAB

5113212400 - CAB-200 (230V50/60) R8 - ACOUSTIC CABINET FANS

5145822200 - ACOP-VENT-200 (V977505)



FLEXIBLE CONNECTOR

5416411600 - CX-125/215

WORM DRIVE DUCT CLIPS



Dimensions



| Dmin | Dmax |
|------|------|
| 125 | 215 |

5132867200 - TTC-2000 (REG-16)



ELECTRICAL HEATER BATTERY CONTROLLER

Dimensions

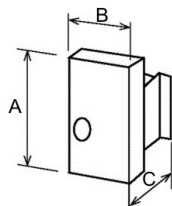

| A | B | C |
|-----|-----|-----|
| 280 | 160 | 140 |



CAB

5113212400 - CAB-200 (230V50/60) R8 - ACOUSTIC CABINET FANS

854001C09 - BEHC 10-40/90

Hygroreglable and timed extraction valves. System updated by the RT 2012, installation on horizontal or vertical walls, removable central grid for ease of maintenance, battery operated control: wireless installation. Kitchen and WC: manual, electric or ba



Dimensions



| D | qd |
|-----|-----|
| 180 | 125 |

L011100000276 - OVER RUN TIMER

Remote (wired) run-on timer, adjustable run-on time 30 seconds to 25 minutes.



Dimensions

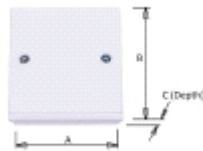

| A | B | C |
|----|----|----|
| 83 | 83 | 40 |

L011100000081 - REB-1 230V 50/60 ELECTRONIC SPEED CONTROLLER

Electronic single phase speed controller, 3-wire control, surface mounted, fuse protected with separate on/off switch.



Dimensions

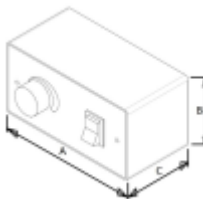

| A | B | C |
|-----|----|----|
| 105 | 83 | 40 |

L011100000388 - 7-DAY PROGRAMMABLE TIMECLOCK



Surface-mount digital 7-day timer.

Dimensions



| A | B | C |
|----|----|----|
| 66 | 98 | 39 |

L011100000414 - CONTACTOR INTERFACE STATION -9A-2 x N/C AND 2 x N/O CONTACTS



9A 2 x N/O / 2 x N/C relay in IP65 enclosure for switching of fans from an external source.

Dimensions

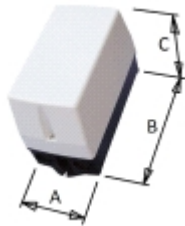

| A | B | C |
|-----|-----|-----|
| 110 | 234 | 149 |

L011100000199 - CONTACTOR INTERFACE STATION - 9A - 4 x N/O CONTACTS



9A N/O relay in IP65 enclosure for switching of fans from an external source, particularly useful for the on/off control of 3-phase units.

Dimensions



| A | B | C |
|-----|-----|-----|
| 110 | 234 | 149 |



CAB

5113212400 - CAB-200 (230V50/60) R8 - ACOUSTIC CABINET FANS

L0111000000541 - RELAY 230V COIL DPDT C/W ENCLOSURE IP65

Double-Pole, Double-throw relay in IP65 enclosure for switching of fans from an external source.



Dimensions



| A | B | C |
|-----|-----|-----|
| 110 | 234 | 149 |

L0111000000275 - PIR SENSOR

PIR SENSOR with Volt-Free contacts and adjustable timer.



Dimensions

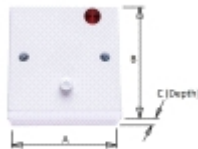

| A | B | C |
|----|----|----|
| 83 | 83 | 55 |

L0111000000389 - THERMOSTAT 230V INPUT

Thermostat for switching of fans by temperature, adjustable temperature range 10-30 degrees C.



Dimensions

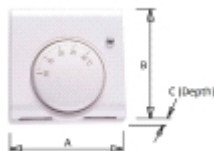

| A | B | C |
|----|----|----|
| 83 | 83 | 40 |



CAB

5113212400 - CAB-200 (230V50/60) R8 - ACOUSTIC CABINET FANS

L0111000000390 - THERMOSTAT 24V INPUT



Thermostat for switching of fans by temperature, adjustable temperature range 10-30 degrees C.

Dimensions

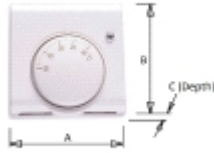

| A | B | C |
|----|----|----|
| 83 | 83 | 40 |

L0111000000589 - CO2 SENSOR WITH VFC (MAX 3A AT 250V) 230V



CO2 Sensor for switching of fans by Carbon Dioxide, adjustable switching points: 800ppm, 1000ppm, 1200ppm, 1400ppm.

Dimensions



| A | B | C |
|----|-----|------|
| 85 | 130 | 38.5 |



ErP Data

| | |
|---|------------------------|
| Ecodesign | |
| Commission regulation (EU) N°1253/2014 of July 2014 | |
| Information requirements (Annex V) | |
| Product Name | CAB-200 (230V50/60) R8 |
| Identifier | 5113212400 |
| SEC average climate (kWh/(m2.an)) | -23,58 |
| SEC class | C |
| SEC cold climate (kWh/(m2.an)) | -51 |
| SEC warm climate (kWh/(m2.an)) | -8 |
| Typology | RVU unidirectional |
| Type of drive | Variable speed drive |
| Type of HRC | None |
| Thermal efficiency (%) | 0 |
| Maximum flow rate (m3/h) | 817 |
| Electrical power input at maximum flow rate (W) | 264,97 |
| Sound power level (LWA) | 54 |
| Reference flow rate (m3/s) | 0,1605 |
| Reference pressure difference (Pa) | 50 |
| SPI (W/m3/h) | 0,357 |
| Control factor | 0,65 |
| Control typology | Local demand |
| Maximum internal leakage for BVU (%) | Not applicable |
| Maximum external leakage for BVU and UVU (%) | 5 |
| Mixing rate for BVU without duct connection (%) | Not applicable |
| Position of visual filter warning | Not applicable |
| description of visual filter warning | Not applicable |
| Instructions to install supply grilles | F&W Leaflet |
| Instructions to install exhaust grilles | F&W Leaflet |
| https://www.solerpalau.com/ | |
| Airflow sensitivity to pressure variation | Not applicable |
| Indoor/outdoor air tightness (m3/h) | Not applicable |
| Annual electricity consumption - Average climate (kWh/a) | 188,94 |
| Annual electricity consumption - Warm climate (kWh/a) | 188,94 |
| Annual electricity consumption - Cold climate (kWh/a) | 188,94 |
| Annual heating saved - Average climate (kWh/a) | 2830 |
| Annual heating saved - Warm climate (kWh/a) | 1279,69 |
| Annual heating saved - Cold climate (kWh/a) | 5536,23 |