

Wall-Mounted Air Intakes/Roof Grills - Grillcirc



Description

Air intake / launcher USAV depending on destination is used as the inlet probe to install intake or launcher for installation in all types of exhaust ventilation. Intakes / USAV launchers are secured with one hand galvanized wire mesh with a diameter of 1 mm and a mesh 2 x 2 mm.

Note:

When mounting the intake/launcher USAV outdoors, be sure to protect it from external factors by painting it in the colors of the facade.

Example identification

Product code: **USAV** - **aaa**

type _____
 Ød _____

Dimensions

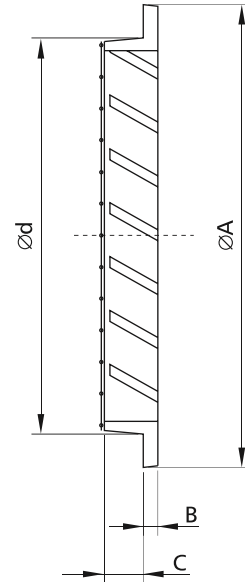

Ød [mm]	ØA [mm]	B [mm]	C [mm]	F [m ²]	weight [kg]
100	125	5,0	15	0,0044	0,16
125	150	5,0	15	0,0068	0,27
150	175	5,0	15	0,0098	0,32
160	185	5,0	15	0,0120	0,37
200	225	5,0	15	0,0200	0,65
250	275	5,0	15	0,0310	1,12
315	350	7,0	15	0,0470	1,90
400	430	1,0	50	0,0750	3,00
500	530	1,0	50	0,1180	5,50
630	660	1,0	50	0,1870	8,80

Wall-Mounted Air Intakes/Roof Grills - Grillcirc

Technical Data

Capacity

The figure shows total pressure P_t (Pa) and noise level L_w (dB(A)) as a function of volumetric air flow q (l/s, m^3/h).

Noise level in free field

The figure shows noise level $L_{w,r}$
Noise level within distance x (m).

$L_A = L_w - K$, see table

