

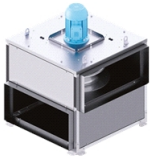

ILHT

5133739300 - ILHT/4-500 CC (230/400V50HZ) N8 - IN-LINE DUCT FANS



Cabinet fan with modular structure certified F400 120 and prepared to transfer air up to 120°C in continuous. Manufactured with galvanized steel sheet panels mounted in an aluminum profile structure that allows multi-directional connections a

Theoretical Working Point

Airflow	-
Static Pressure	0,000 Pa
Temperature	20 °C
Altitude	0 m
Density	1,2 kg/m ³
Frequency	50 Hz

Construction

Discharge diameter	500 mm
Fan size	500
Blades	0
Weight	114,00 kg

Motor Characteristics

Number of poles	4
Motor Power	1,5 kW
Maximum absorbed current	5,5 A / 3,2 A
Voltage	3-230/400V-50Hz
IP Rating	IP55
Motor insulation class	F



Performance Chart

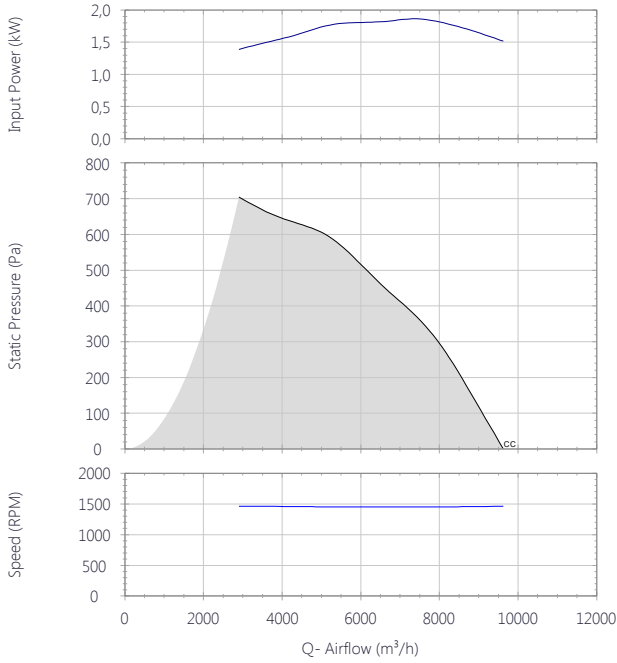

Drawing

A	BH	BVC	C	D	EC	F	GC	H
858	925	784	338	768	1039	890	62	402
I	J	KC	L					
55	112	1145	351					

Sound Performance

	63	125	250	500	1k	2k	4k	8k	Overall
Inlet (LwA)	63	73	75	77	79	78	74	67	85
Inlet LpA @ 1m	52	62	64	66	68	68	63	56	74
Outlet (LwA)	66	82	87	87	90	85	80	73	94
Outlet LpA @ 1m	55	71	76	76	79	74	69	62	83
Breakout (LwA)	49	60	63	62	73	63	59	53	74
Breakout LpA @ 1m	38	49	52	51	62	52	48	42	63





Performance Chart

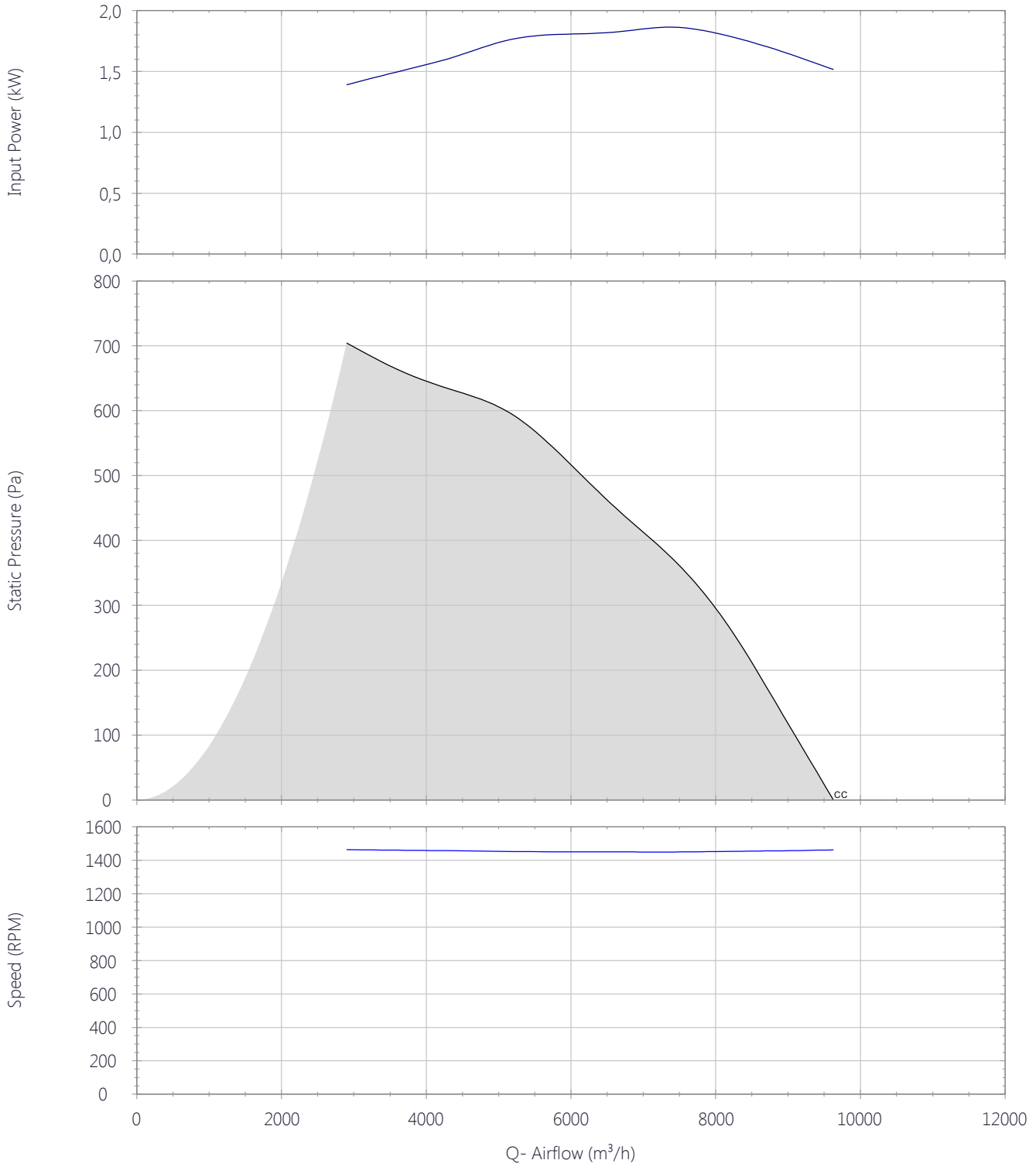



Sound Performance

	63	125	250	500	1k	2k	4k	8k	Overall
Inlet (LwA)	63	73	75	77	79	78	74	67	85
Inlet LpA @ 1m	52	62	64	66	68	68	63	56	74
Outlet (LwA)	66	82	87	87	90	85	80	73	94
Outlet LpA @ 1m	55	71	76	76	79	74	69	62	83
Breakout (LwA)	49	60	63	62	73	63	59	53	74
Breakout LpA @ 1m	38	49	52	51	62	52	48	42	63





ILHT

5133739300 - ILHT/4-500 CC (230/400V50HZ) N8 - IN-LINE DUCT FANS

Drawing

A	BH	BVC	C	D	EC	F	GC	H	I	J	KC	L
858	925	784	338	768	1039	890	62	402	55	112	1145	351



ILHT

5133739300 - ILHT/4-500 CC (230/400V50HZ) N8 - IN-LINE DUCT FANS

Accessories

L1000000662 - S&P VFD-M 10A IP54 (1-PH)



Single-phase 230V-50/60Hz Voltage supply. Motor kW protection programmable by a single parameter. Power on and drive status indication. Speed selection with UP/DOWN keys. Run/Fault relay output contacts. Motor overload and shortcut protections.

Dimensions

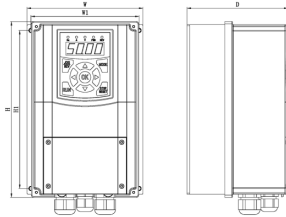

H	H1	W	W1	D	d
193	170	150	140	131	4.5

5401227500 - VFTM320 MONO 1,10 IP66



Adjustable frequency drive. Single phase supply 230V-50/60Hz, three phase 230V output.

Dimensions

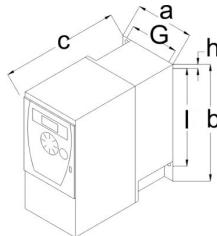

a	b	c	G	I	h
250	340	235	231	323	6.6

5401225600 - VFTM320 MONO 1,10



Adjustable frequency drive. Single phase supply 230V-50/60Hz, three phase 230V output.

Dimensions

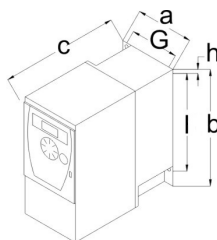

a	b	c	G	I	h
105	142	158	93	118	5

5401227600 - VFTM320 MONO 1,5 IP66



Adjustable frequency drive. Single phase supply 230V-50/60Hz, three phase 230V output.

Dimensions

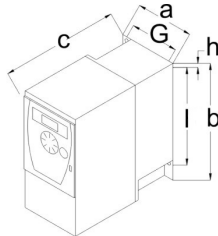

a	b	c	G	I	h
250	340	235	231	323	6.6

5401225700 - VFTM320 MONO 1,5



Adjustable frequency drive. Single phase supply 230V-50/60Hz, three phase 230V output.

Dimensions

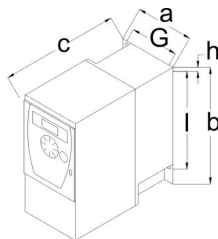

a	b	c	G	I	h
105	142	158	93	118	5

L1000000664 - S&P VFD-T 5A IP54 (3-PH)



Three-phase 400V-50/60Hz Voltage supply. Motor kW protection programmable by a single parameter. Power on and drive status indication. Speed selection with UP/DOWN keys. Run/Fault relay output contacts. Motor overload and shortcut protections.

Dimensions

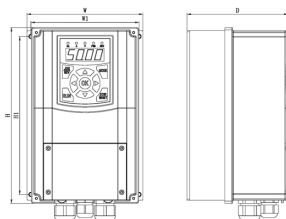

H	H1	W	W1	D	d
193	170	150	140	131	4.5



5401228200 - VFTM320 TRI 1,5 IP66



Adjustable frequency drive. Three phase supply 400V-50/60Hz, three phase 400V output.

Dimensions

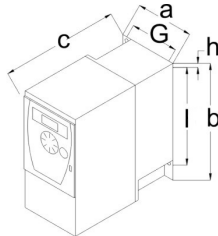

a	b	c	G	I	h
250	340	200	231	323	6.6

5401226300 - VFTM320 TRI 1,5



Adjustable frequency drive. Three phase supply 400V-50/60Hz, three phase 400V output.

Dimensions

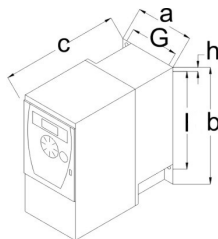

a	b	c	G	I	h
105	142	158	93	118	5

5401617800 - VFKB-24



Adjustable frequency drive with die cast aluminium IP55 case. Single phase supply (230V 50/60Hz), three phase 230V output .

Dimensions

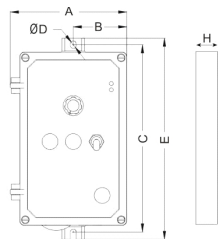

A
140



ILHT

5133739300 - ILHT/4-500 CC (230/400V50HZ) N8 - IN-LINE DUCT FANS



5133754800 - ILAR-500

Rectangular flexible connector



Dimensions

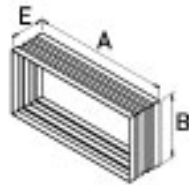

A	B	E
768	341	160

5133035600 - ICAH-500

Horizontal backdraft shutter



Dimensions

A	B	C
768	338	80

5133034500 - ICAV-500

Vertical backdraft shutter



Dimensions

A	B	C
768	338	80



ILHT

5133739300 - ILHT/4-500 CC (230/400V50HZ) N8 - IN-LINE DUCT FANS

5416988500 - ISA-ILHT-500/560/630



Antivibration mounts

5133759300 - ILTM-500/560/630



Motor cover

Dimensions

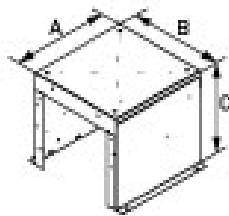

A	B	C
415	475	355

5133758000 - ILVH-500

Outdoor protection guard- Horizontal motor shaft



Dimensions

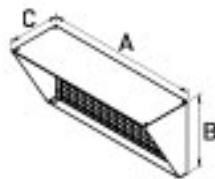

A	B	D
768	338	249



ILHT

5133739300 - ILHT/4-500 CC (230/400V50HZ) N8 - IN-LINE DUCT FANS



5133757200 - ILVV-500

Outdoor protection guard- Vertical motor shaft



Dimensions

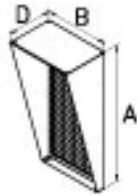

A	B	C
768	338	240

5138921400 - ACOPEL F400-560/160 N

FLEXIBLE CONNECTOR



Dimensions

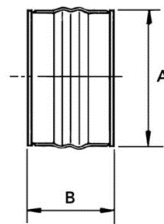

A	B
568	160

5133036500 - IJKH-500

Manual adjustment damper



Dimensions

A	B	C
768	338	256



ILHT

5133739300 - ILHT/4-500 CC (230/400V50HZ) N8 - IN-LINE DUCT FANS



L0111000000414 - CONTACTOR INTERFACE STATION - 9A-2 x N/C AND 2 x N/O CONTACTS

9A 2 x N/O / 2 x N/C relay in IP65 enclosure for switching of fans from an external source.



Dimensions

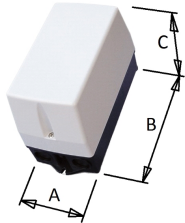

A	B	C
110	234	149

L0111000000199 - CONTACTOR INTERFACE STATION - 9A - 4 x N/O CONTACTS

9A N/O relay in IP65 enclosure for switching of fans from an external source, particularly useful for the on/off control of 3-phase units.



Dimensions

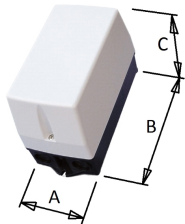

A	B	C
110	234	149