

KVK Slim 160 EC

Centrifugal circular duct fan <125W

Item Number: 92151

Variant: 230V 1~ 50/60Hz



- Slim design, easy to install
- Easy maintenance, service cover
- Low sound level, insulated cover
- High efficiency and low SFP in a real working point
- Potentiometer included, possible to speed control 0-100%
- Simple to install, mounting brackets included
- Integrated motor protection
- Aluzinc casing, C4 corrosion class

KVK Slim is a box fan with circular duct connections. The lid is insulated to keep a low sound level. The fan can be installed in any position. The casing is manufactured from Aluzinc in corrosion class C4. A service cover with screw connection makes it easy to open for service and cleaning.



KVK Slim EC is delivered with integrated motor protection and pre-wired potentiometer (0-10V) that allows you to easily find the desired working point. The fan can be demand controlled via sensors for CO₂, temperature, humidity, presence indication and VAV.

Size 315-500 also offers possibility to communication via Modbus.

The FK mounting clamp (accessory) facilitates easy installation and removal and prevents the transfer of vibration to the duct.

Technical parameters

Nominal data		
Voltage (nominal)	230	V
Frequency	60; 50	Hz
Phase(s)	1~	
Input power	120	W
Input current	0.925	A
Impeller speed	2,553	rpm
Air flow	max 0.204	m ³ /s
Temperature of transported air	max 60	°C
Max temperature of transported air, when speed controlled	60	°C
Sound data		
Sound pressure level at 3m (20m ² Sabin)	51	dB(A)
Protection/Classification		
Enclosure class, motor	IP54	
Insulation class	B	

Data according to ErP

Energy class, Basic unit	E
Energy class, Local demand	B
ErP ready	ErP 2018

Dimensions and weights

Duct dimension; Circular, inlet	160 mm
Duct dimension; Circular, outlet	160 mm
Weight	6 kg

Others

Duct connection type	Circular
Motor type	EC

Performance

Performance curve

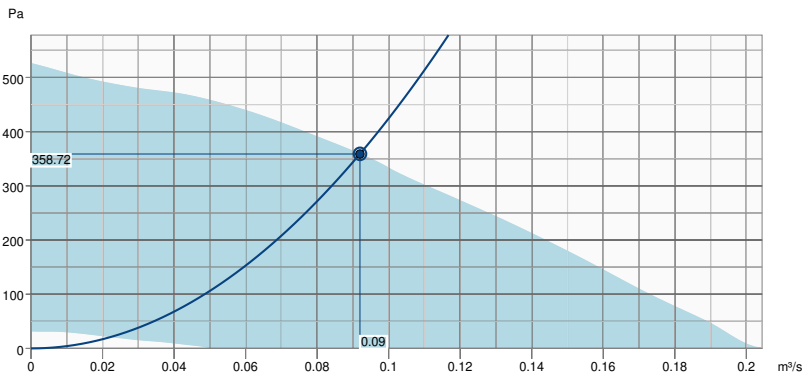

Hydraulic data	
Required air flow	0.09 m³/s
Required static pressure	359 Pa
Working air flow	0.09 m³/s
Working static pressure	359 Pa
Air density	1.204 kg/m³
Power	113.9 W
Fan control - RPM	2613 rpm
Current	0.88 A
SFP	1.238 kW/m³/s
Control voltage	10.0 V
Supply voltage	230 V

Sound power level		63	125	250	500	1k	2k	4k	8k	Total
Inlet	dB(A)	57	64	69	68	63	60	56	50	73
Outlet	dB(A)	54	58	71	64	61	60	55	49	73
Surrounding	dB(A)	31	43	52	54	49	48	47	40	58
Sound pressure level at 3m (20m² Sabine)	dB(A)	-	-	-	-	-	-	-	-	51
Sound pressure level at 3m free field	dB(A)	-	-	-	-	-	-	-	-	37

Dimension

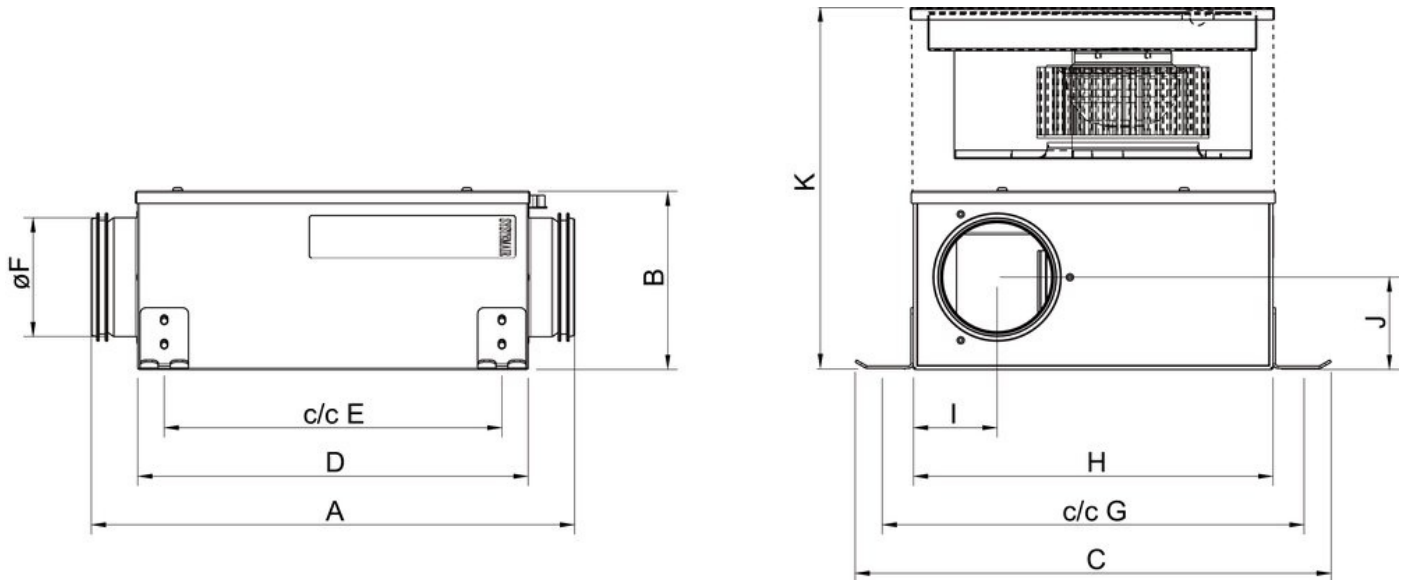

	A	B	C	D	E	øF	G	H	I	J	K
KVK Slim 100	400	150	392	325	278	98	348	300	69	76	300
KVK Slim 125	400	150	392	325	278	123	348	300	84	72	300
KVK Slim 160	400	185	392	325	278	158	348	300	99	90	370
KVK Slim100 EC	400	150	392	325	278	98	348	300	69	76	300
KVK Slim120 EC	400	150	392	325	278	123	348	300	84	72	300
KVK Slim160 EC	400	185	392	325	278	158	348	300	99	90	370

Wiring

230V 1~

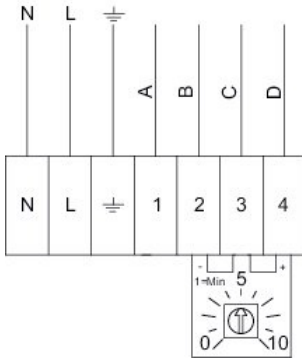

Terminal	Cable	Description
1	Black 1	Tacho output, Isink max 10mA
2	Black 2	GND
3	Black 3	Control input 0-10 VDC/PWM
4	Black 4	Output 10 VDC max 1.1 mA

Ecodesign

Product	
Trade name	Systemair
Product name	KVK Slim 160 EC
Basic unit	
ErP compliance	2016
SEC Average	-13.9 kWh/(m ² .a)
SEC Cold	-30.4 kWh/(m ² .a)
SEC Warm	-4.6 kWh/(m ² .a)
SEC Class	E
Unit category	RVU
Unit type	UVU
Drive	Integrated VSD
Heat recovery type	None
Temperature ratio (UVU)	Not applicable
qv max	623 m ³ /h
P max	120 W
Sound power level LWA	53 dB(A)
qv ref	0.121 m ³ /s
Ps ref	50 Pa
SPI	0.102 W/(m ³ /h)
CTRL	1
MISC	1.1
x-value	2
External Leakage	0.3 %
AEC average	127 kWh
AHS Cold	127 kWh
AEC warm	127 kWh
AHS Average	17 kWh/a
AHS Cold	34 kWh/a
AHS Warm	8 kWh/a

Units with local demand control

ErP compliance	2018
SEC Average	-27 kWh/(m ² .a)
SEC Cold	-54 kWh/(m ² .a)
SEC Warm	-11.5 kWh/(m ² .a)
SEC Class	B
Unit category	RVU
Unit type	UVU
Drive	Integrated VSD
Heat recovery type	None
Temperature ratio (UVU)	Not applicable
qv max	623 m ³ /h
P max	120 W
Sound power level LWA	53 dB(A)
qv ref	0.12 m ³ /s
Ps ref	50 Pa
SPI	0.102 W/(m ³ /h)
CTRL	0.65
MISC	1.1
x-value	2
External Leakage	0.3 %
AEC average	54 kWh
AEC cold	54 kWh
AEC warm	54 kWh
AHS Average	28 kWh/a
AHS Cold	55 kWh/a
AHS Warm	13 kWh/a

Energy class label

Energy class, Basic unit

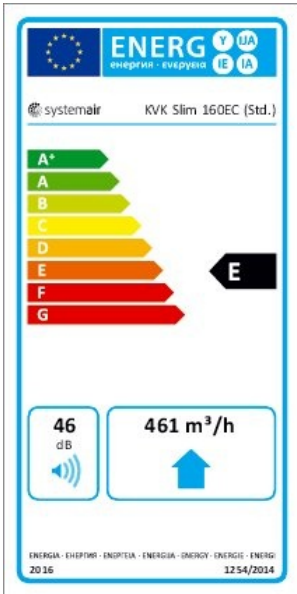

Energy class, Local demand

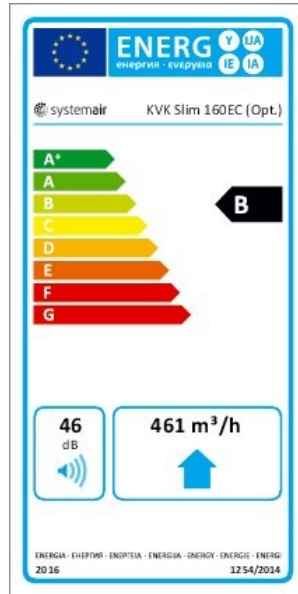

Accessories

- CXE/AVC Modbus (37256)
- EC-Basic-CO2 and temperature (24808)
- EC-Basic-T temperature (24805)
- EC-Selector (9908)
- EC-Vent Room Unit (3018)
- MTP 10, 10K, Speed control (32731)
- MTV-1/010 Controller 0..10V+ (30650)
- S-5EC/FRQ (76738)
- VKK-160 Back draft damper (1625)
- HR1 Room Humidistat (215150)
- RT 0-30 Room Thermostat (5151)
- CB 160-2,1 230V/1 Duct heater (5292)
- CB 160-5,0 400V/2 Duct heater (5383)
- CBMF 160-2,1 230V/1 Duct heater (12244)
- FFR 160 Filter cassette (1770)
- FK 160 Fast clamp (1610)
- LDC 160-600 Silencer (5192)
- RSK-160 Back draft damper (5601)
- VBC 160-3 Water heating batt (9840)
- BMS Trickle & Boost Switch (120363)
- DMD-C Pressure controller (15793)
- EC-Basic-H humidity (24807)
- EC-Basic-U universal 0-10V (24806)
- EC-Vent control board (3115)
- IGK-160 Wall Grid (1632)
- MTP 20, on/off, 3-step (310220)
- REV-3POL/03-7,5kW R/Y (33978)
- SG 160 Protection guard (5608)
- CO2RT-R-D Transmitter (6993)
- Presence detector/IR24-P (6995)
- CB 160-1,2 230V/1 Duct heater (5291)
- CB 160-2,7 230V/1 Duct heater (5382)
- CBM 160-2,1 230V/1 Duct heater (5482)
- CWK 160-3-2,5 Duct cooler,circ (30022)
- FGR 160 Filter cassette (1809)
- LDC 160-300 Silencer (53108)
- LDC 160-900 Silencer (5193)
- VBC 160-2 Water heating batt (5458)
- VBF 160 Water heating battery (1731)